



RÖDER HTS HÖCKER
GMBH



2007-2008

Industrial Structures

Product line:



In use around the world and operating in some of the most demanding environments, the RÖDER HTS WS & L-Series Industrial Building System provides instant, semi-permanent, re-locatable space solutions suitable for all types of use. Be it general warehousing, temporary trading floors, factories, cold storage or showrooms, we have an affordable and flexible solution to suit your budget and requirements.

Standard industrial structures are available in clear-span widths from 5.00m – 30.00m with varying eave heights from 4.20m – 6.20m. Our buildings are modular by design and can be increased or decreased in length as and when required, and, reflecting their design flexibility, they can be installed without the need for complex and expensive foundations.

Industrial buildings are calculated for snow-loading up to 75kgm². Higher snow loadings, span widths and eave heights are available on special request.

All industrial buildings are available in a variety of formats. Wall sections can be supplied in PVC, corrugated steel sheet and 40mm, 60mm or 80mm sandwich panel walling ensuring optimal thermal

values. These systems also extend to the roof which can be constructed from single layer PVC, inflatable “thermo” twin layers or insulated steel roof systems ensuring minimum internal draughts and savings on heating costs. All structures are available with a full range of accessories. These include lighting, floor systems, roller shutter and personnel doors – whatever the application RÖDER HTS HÖCKER has it covered.





Industrial Structures





Frame Specifications

Span width:
5.00m | 7.50m

Eave height:
3.50m | 4.40m

Ridge height:
5.07m | 5.40m

Bay spacing:
2.50m

Roof pitch:
15.00°

Longest component:
4.06m | 4.28m

Wind loading:
102.00km/h (0.50kN/m²)

Snow loading:
25.00kg/m²

Profiles & Connections

Upright truss:
170/88/3mm (4-channel)

Eave purlin:
50/50/3mm

Intermediate purlin:
50/50/2mm

Ridge purlin:
50/50/2mm

Eave connection:
Galvanised steel insert

Material Specifications

Aluminium (framework)
Hard pressed extruded aluminium

Steel (connections)
European - hot dipped galvanised to DIN 50976

PVC covering
Available in single layer or thermo style - manufactured from high gloss translucent or opaque PVC coated polyester flame retardant according to DIN 4102 B1, M.2., B.S. 5438 / 7837, USA NFPA 701.

Flooring Systems

System 1
Heavy duty sub-construction floor

System 2
Cassette flooring system

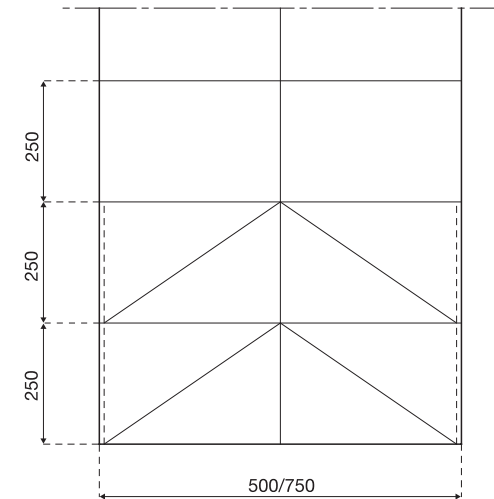
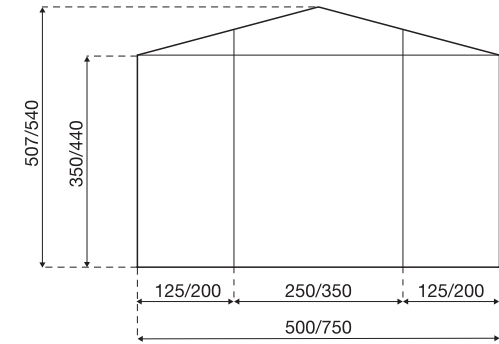

Optional Accessories

- 40/60/80mm Insulated walling
- Corrugated steel sheet walling
- Water sealed walls
- Fire sprinkler systems
- Black-out roof systems
- PVC or steel guttering
- Heating & air conditioning
- Canopies & racking
- Glazed windows & lighting
- Roller & sliding doors
- Personnel door unit





Frame Specifications

Span width:
10.00m | 12.50m

Eave height:
4.40m

Ridge height:
5.74m | 6.08m

Bay spacing:
2.50m

Roof pitch:
15.00°

Longest component:
5.26m | 6.56m

Wind loading:
102.00km/h (0.50kN/m²)

Snow loading:
25.00kg/m²

Profiles & Connections

Upright truss:
170/88/3mm (4-channel)

Eave purlin:
50/50/3mm

Intermediate purlin:
50/50/2mm

Ridge purlin:
50/50/2mm

Eave connection:
Galvanised steel insert

Material Specifications

Aluminium (framework)
Hard pressed extruded aluminium

Steel (connections)
European - hot dipped galvanised to DIN 50976

PVC covering
Available in single layer or thermo style - manufactured from high gloss translucent or opaque PVC coated polyester flame retardant according to DIN 4102 B1, M.2., B.S. 5438 / 7837, USA NFPA 701.

Flooring Systems

System 1
Heavy duty sub-construction floor

System 2
Cassette flooring system

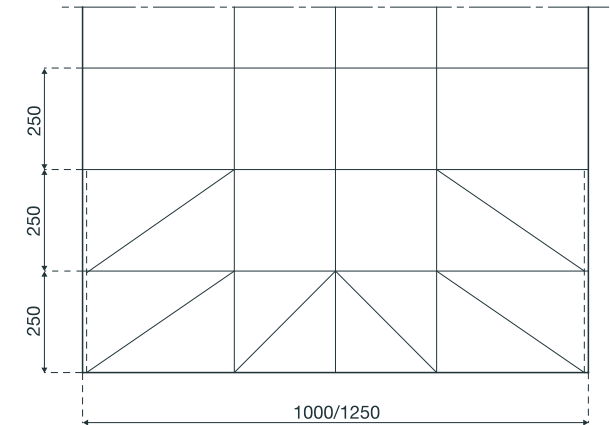
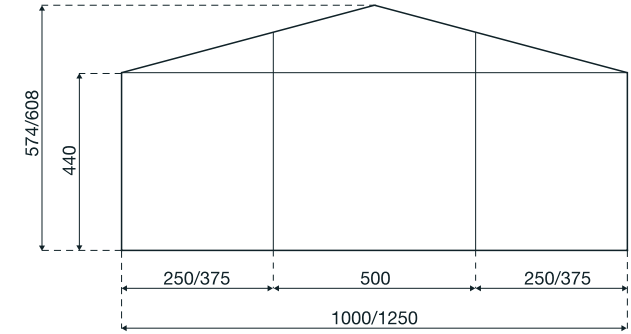

Optional Accessories

- 40/60/80mm Insulated walling
- Corrugated steel sheet walling
- Water sealed walls
- Fire sprinkler systems
- Black-out roof systems
- PVC or steel guttering
- Heating & air conditioning
- Canopies & racking
- Glazed windows & lighting
- Roller & sliding doors
- Personnel door unit



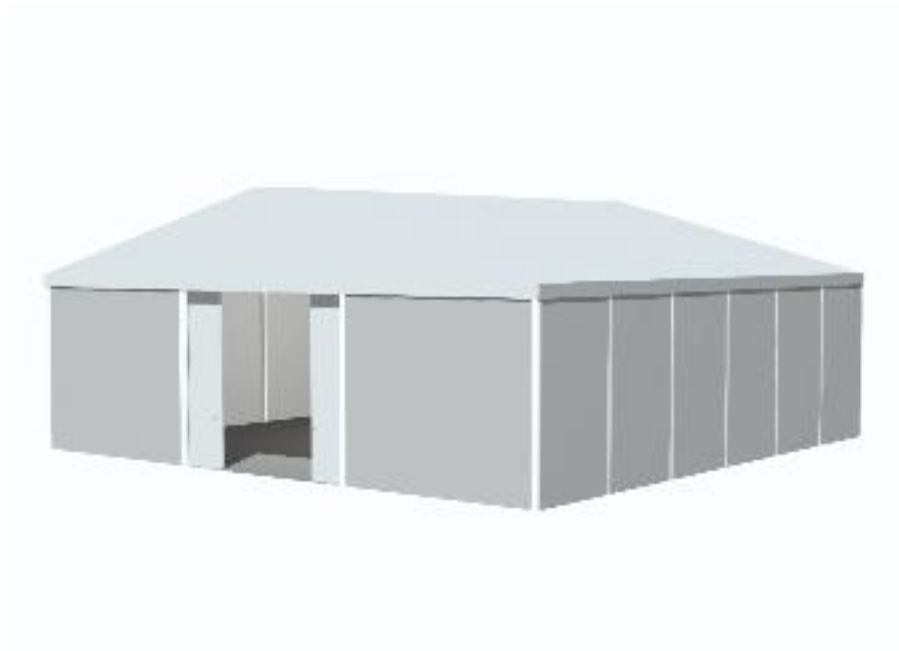

Frame Specifications

- Span width:
15.00m
- Eave height:
4.40m
- Ridge height:
6.41m
- Bay spacing:
2.50m
- Roof pitch:
15.00°
- Longest component:
7.85m
- Wind loading:
102.00km/h (0.50kN/m²)
- Snow loading:
25.00kg/m²

Profiles & Connections

- Upright truss:
170/88/3mm (4-channel)
- Eave purlin:
50/50/3mm
- Intermediate purlin:
50/50/2mm
- Ridge purlin:
50/50/2mm
- Eave connection:
Galvanised steel insert

Material Specifications

- Aluminium (framework)
Hard pressed extruded aluminium
- Steel (connections)
European - hot dipped galvanised to DIN 50976
- PVC covering
Available in single layer or thermo style - manufactured from high gloss translucent or opaque PVC coated polyester flame retardant according to DIN 4102 B1, M.2., B.S. 5438 / 7837, USA NFPA 701.

Flooring Systems

- System 1
Heavy duty sub-construction floor
- System 2
Cassette flooring system

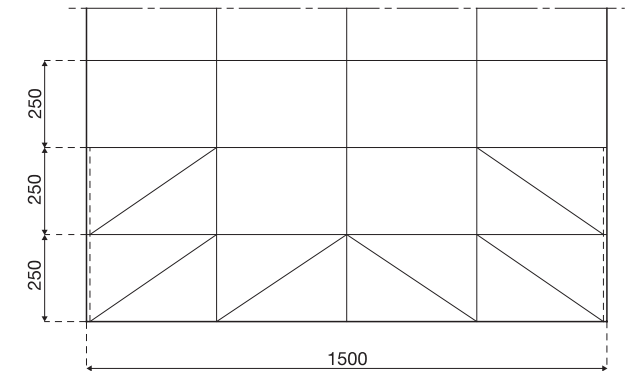
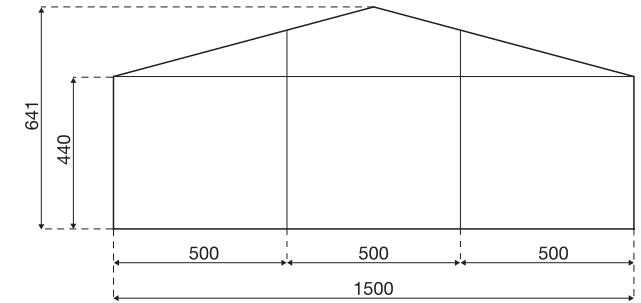

Optional Accessories

- 40/60/80mm Insulated walling
- Corrugated steel sheet walling
- Water sealed walls
- Fire sprinkler systems
- Black-out roof systems
- PVC or steel guttering
- Heating & air conditioning
- Canopies & racking
- Glazed windows & lighting
- Roller & sliding doors
- Personnel door unit





Frame Specifications

- Span width:
20.00m
- Eave height:
4.40m
- Ridge height:
7.08m
- Bay spacing:
2.50m
- Roof pitch:
15.00°
- Longest component:
10.44m
- Wind loading:
102.00km/h (0.50kN/m²)
- Snow loading:
25.00kg/m²

Profiles & Connections

- Upright truss:
170/88/3mm (4-channel)
- Eave purlin:
50/50/3mm
- Intermediate purlin:
50/50/2mm
- Ridge purlin:
50/50/2mm
- Eave connection:
Galvanised steel insert

Material Specifications

- Aluminium (framework)
Hard pressed extruded aluminium
- Steel (connections)
European - hot dipped galvanised to DIN 50976
- PVC covering
Available in single layer or thermo style - manufactured from high gloss translucent or opaque PVC coated polyester flame retardant according to DIN 4102 B1, M.2., B.S. 5438 / 7837, USA NFPA 701.

Flooring Systems

- System 1
Heavy duty sub-construction floor
- System 2
Cassette flooring system

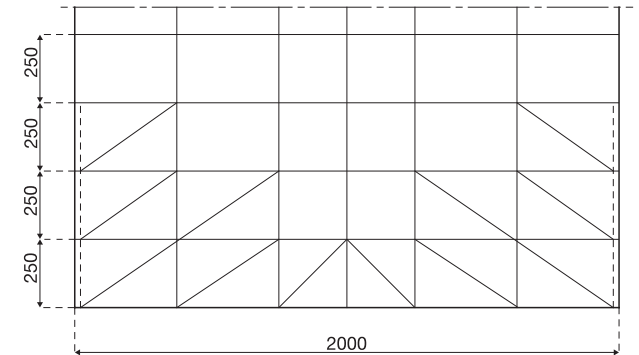
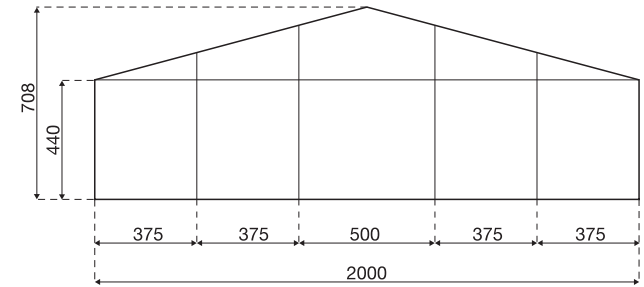

Optional Accessories

- 40/60/80mm Insulated walling
- Canopies & racking
- Corrugated steel sheet walling
- Glazed windows & lighting
- Water sealed walls
- Roller & sliding doors
- Fire sprinkler systems
- Personnel door unit
- Black-out roof systems
- PVC or steel guttering
- Heating & air conditioning





Frame Specifications

- Span width:
15.00m
- Eave height:
4.40m
- Ridge height:
6.41m
- Bay spacing:
2.50m
- Roof pitch:
15.00°
- Longest component:
7.85m
- Wind loading:
102.00km/h (0.50kN/m²)
- Snow loading:
75.00kg/m²

Profiles & Connections

- Upright truss:
252/120/4.35/5.35mm (4-channel)
- Eave purlin:
50/50/3mm
- Intermediate purlin:
50/50/2mm
- Ridge purlin:
50/50/2mm
- Eave connection:
Galvanised steel insert

Material Specifications

- Aluminium (framework)
Hard pressed extruded aluminium
- Steel (connections)
European - hot dipped galvanised to DIN 50976
- PVC covering
Available in single layer or thermo style - manufactured from high gloss translucent or opaque PVC coated polyester flame retardant according to DIN 4102 B1, M.2., B.S. 5438 / 7837, USA NFPA 701.

Flooring Systems

- System 1
Heavy duty sub-construction floor
- System 2
Cassette flooring system

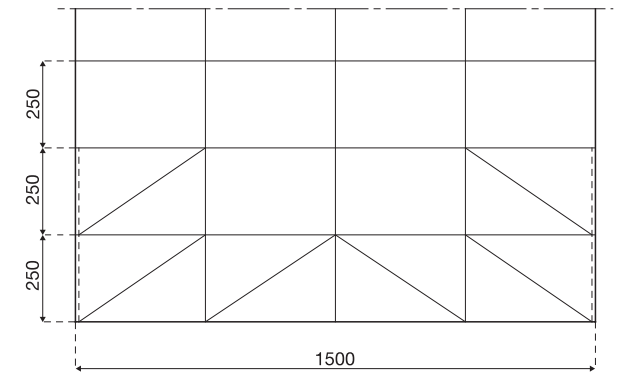
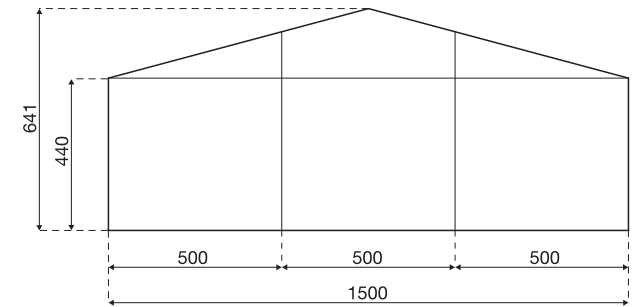

Optional Accessories

- 40/60/80mm Insulated walling
- Canopies & racking
- Corrugated steel sheet walling
- Glazed windows & lighting
- Water sealed walls
- Roller & sliding doors
- Fire sprinkler systems
- Personnel door unit
- Black-out roof systems
- PVC or steel guttering
- Heating & air conditioning





Frame Specifications

- Span width:
20.00m
- Eave height:
4.40m
- Ridge height:
7.08m
- Bay spacing:
2.50m
- Roof pitch:
15.00°
- Longest component:
10.44m
- Wind loading:
102.00km/h (0.50kN/m²)
- Snow loading:
75.00kg/m²

Profiles & Connections

- Upright truss:
288/123/9/4.5mm (4-channel)
- Eave purlin:
50/50/3mm
- Intermediate purlin:
50/50/2mm
- Ridge purlin:
50/50/2mm
- Eave connection:
Galvanised steel insert

Material Specifications

- Aluminium (framework)
Hard pressed extruded aluminium
- Steel (connections)
European - hot dipped galvanised to DIN 50976
- PVC covering
Available in single layer or thermo style - manufactured from high gloss translucent or opaque PVC coated polyester flame retardant according to DIN 4102 B1, M.2., B.S. 5438 / 7837, USA NFPA 701.

Flooring Systems

- System 1
Heavy duty sub-construction floor
- System 2
Cassette flooring system

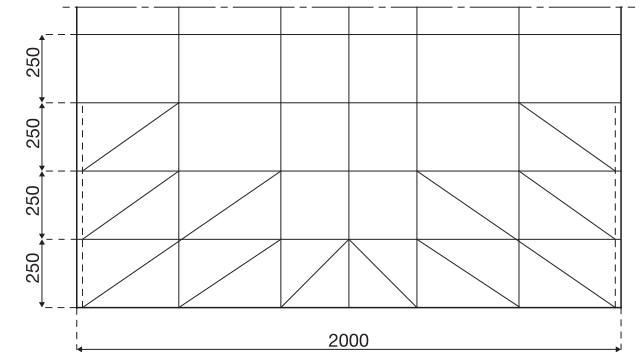
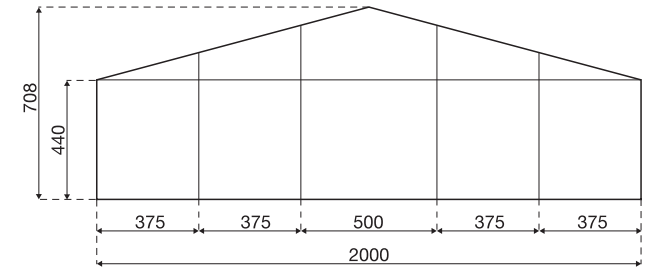

Optional Accessories

- 40/60/80mm Insulated walling
- Canopies & racking
- Corrugated steel sheet walling
- Glazed windows & lighting
- Water sealed walls
- Roller & sliding doors
- Fire sprinkler systems
- Personnel door unit
- Black-out roof systems
- PVC or steel guttering
- Heating & air conditioning





Frame Specifications

- Span width:
10.00m
- Eave height:
4.20m | 5.20m
- Ridge height:
5.85m | 6.85m
- Bay spacing:
5.00m
- Roof pitch:
18.00°
- Longest component:
5.50m
- Wind loading:
100.00km/h (0.47kN/m²)
- Snow loading:
75.00kg/m²

Profiles & Connections

- Upright truss:
252/122/4mm
- Eave purlin:
120/80/5mm
- Intermediate purlin:
120/80/5mm
- Ridge purlin:
120/80/5mm
- Eave connection:
Galvanised steel insert

Material Specifications

- Aluminium (framework)
Hard pressed extruded aluminium
- Steel (connections)
European - hot dipped galvanised to DIN 50976
- PVC covering
Available in single layer or thermo style - manufactured from high gloss translucent or opaque PVC coated polyester flame retardant according to DIN 4102 B1, M.2., B.S. 5438 / 7837, USA NFPA 701.

Flooring Systems

- System 1
Heavy duty sub-construction floor
- System 2
Cassette flooring system

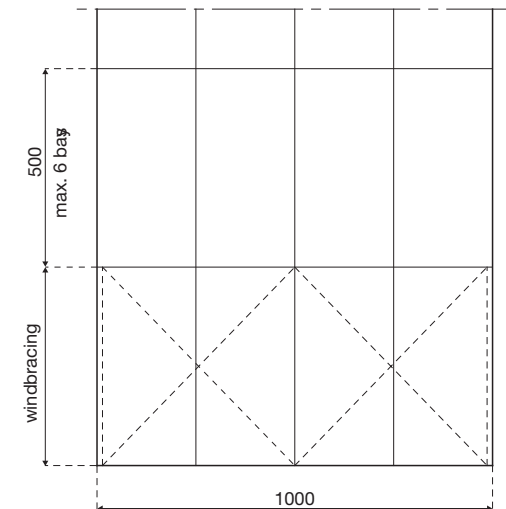
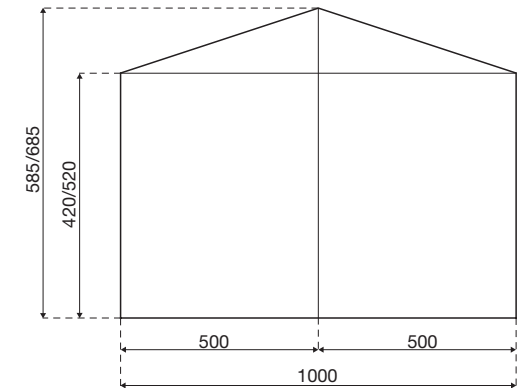

Optional Accessories

- 40/60/80mm Insulated walling
- Corrugated steel sheet walling
- Water sealed walls
- Fire sprinkler systems
- Black-out roof systems
- PVC or steel guttering
- Heating & air conditioning
- Canopies & racking
- Glazed windows & lighting
- Roller & sliding doors
- Personnel door unit





Frame Specifications

- Span width:
10.00m
- Eave height:
6.20m
- Ridge height:
7.85m
- Bay spacing:
5.00m
- Roof pitch:
18.00°
- Longest component:
6.20m
- Wind loading:
100.00km/h (0.47kN/m²)
- Snow loading:
75.00kg/m²

Profiles & Connections

- Upright truss:
334/122/8mm
- Eave purlin:
120/120/5mm
- Intermediate purlin:
120/80/5mm
- Ridge purlin:
120/80/5mm
- Eave connection:
Galvanised steel insert

Material Specifications

- Aluminium (framework)
Hard pressed extruded aluminium
- Steel (connections)
European - hot dipped galvanised to DIN 50976
- PVC covering
Available in single layer or thermo style - manufactured from high gloss translucent or opaque PVC coated polyester flame retardant according to DIN 4102 B1, M.2., B.S. 5438 / 7837, USA NFPA 701.

Flooring Systems

- System 1
Heavy duty sub-construction floor
- System 2
Cassette flooring system

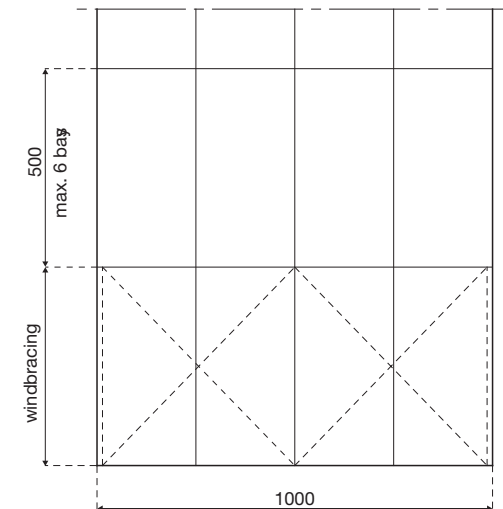
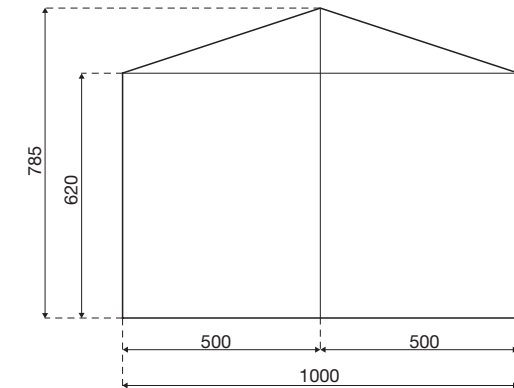

Optional Accessories

- 40/60/80mm Insulated walling
- Corrugated steel sheet walling
- Water sealed walls
- Fire sprinkler systems
- Black-out roof systems
- PVC or steel guttering
- Heating & air conditioning
- Canopies & racking
- Glazed windows & lighting
- Roller & sliding doors
- Personnel door unit



Industrial Structures

Warehouse Structures - L Series

L1500/420/668
L1500/520/763
L1500/620/868



Frame Specifications

Span width:
15.00m

Eave height:
4.20m | 5.20m | 6.20m

Ridge height:
6.68m | 7.63m | 8.68m

Bay spacing:
5.00m

Roof pitch:
18.00°

Longest component:
8.00m

Wind loading:
100.00km/h (0.47kN/m²)

Snow loading:
75.00kg/m²

Profiles & Connections

Upright truss:
252/122/4mm | 334/122/8mm

Eave purlin:
120/80/5mm | 120/120/5mm

Intermediate purlin:
120/80/5mm

Ridge purlin:
120/80/5mm

Eave connection:
Galvanised steel insert

Material Specifications

Aluminium (framework)
Hard pressed extruded aluminium

Steel (connections)
European - hot dipped galvanised to DIN 50976

PVC covering
Available in single layer or thermo style - manufactured from high gloss translucent or opaque PVC coated polyester flame retardant according to DIN 4102 B1, M.2., B.S. 5438 / 7837, USA NFPA 701.

Flooring Systems

System 1
Heavy duty sub-construction floor

System 2
Cassette flooring system

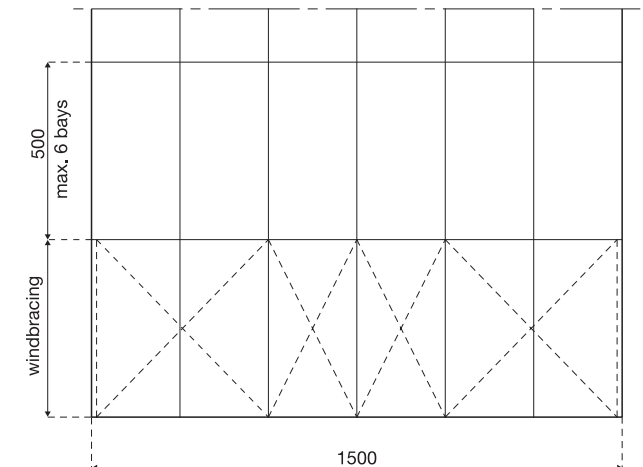
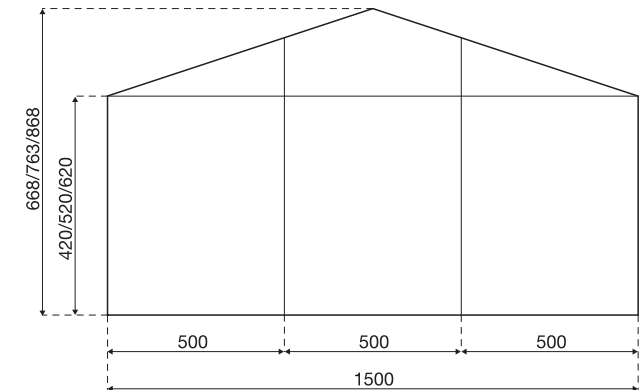

Optional Accessories

40/60/80mm Insulated walling	Canopies & racking
Corrugated steel sheet walling	Glazed windows & lighting
Water sealed walls	Roller & sliding doors
Fire sprinkler systems	Personnel door unit
Black-out roof systems	
PVC or steel guttering	
Heating & air conditioning	



Industrial Structures

Warehouse Structures - L Series

L2000/420/749
L2000/520/848
L2000/620/948



Frame Specifications

Span width:
20.00m

Eave height:
4.20m | 5.20m | 6.20m

Ridge height:
7.49m | 8.48m | 9.48m

Bay spacing:
5.00m

Roof pitch:
18.00°

Longest component:
9.99m | 10.65m

Wind loading:
100.00km/h (0.47kN/m²)

Snow loading:
25.00kg/m² | 75.00kg/m²

Profiles & Connections

Upright truss:
252/122/4mm | 344/122/8mm | 334/122/8mm

Eave purlin:
120/80/5mm | 120/120/5mm

Intermediate purlin:
120/80/5mm

Ridge purlin:
120/80/5mm

Eave connection:
Galvanised steel insert

Material Specifications

Aluminium (framework)
Hard pressed extruded aluminium

Steel (connections)
European - hot dipped galvanised to DIN 50976

PVC covering
Available in single layer or thermo style - manufactured from high gloss translucent or opaque PVC coated polyester flame retardant according to DIN 4102 B1, M.2., B.S. 5438 / 7837, USA NFPA 701.

Flooring Systems

System 1
Heavy duty sub-construction floor

System 2
Cassette flooring system

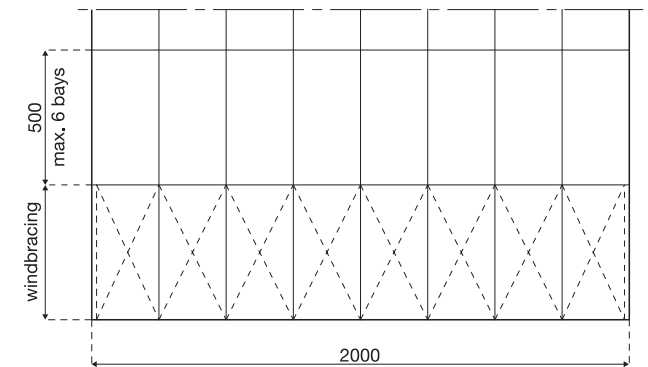
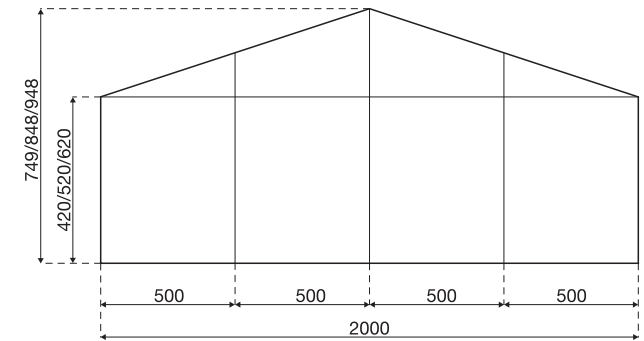

Optional Accessories

40/60/80mm Insulated walling	Canopies & racking
Corrugated steel sheet walling	Glazed windows & lighting
Water sealed walls	Roller & sliding doors
Fire sprinkler systems	Personnel door unit
Black-out roof systems	
PVC or steel guttering	
Heating & air conditioning	





Frame Specifications

Span width:
25.00m

Eave height:
4.20m | 5.20m | 6.20m

Ridge height:
8.34m | 9.34m | 10.34m

Bay spacing:
5.00m

Roof pitch:
18.00°

Longest component:
13.28m | 10.80m

Wind loading:
100.00km/h (0.47kN/m²)

Snow loading:
25.00kg/m² | 75.00kg/m²

Profiles & Connections

Upright truss:
252/122/4mm | 334/112/8mm | 334/122/8mm

Eave purlin:
120/80/5mm | 120/120/5mm

Intermediate purlin:
120/80/5mm

Ridge purlin:
120/80/5mm

Eave connection:
Galvanised steel insert

Material Specifications

Aluminium (framework)
Hard pressed extruded aluminium

Steel (connections)
European - hot dipped galvanised to DIN 50976

PVC covering
Available in single layer or thermo style - manufactured from high gloss translucent or opaque PVC coated polyester flame retardant according to DIN 4102 B1, M.2., B.S. 5438 / 7837, USA NFPA 701.

Flooring Systems

System 1
Heavy duty sub-construction floor

System 2
Cassette flooring system

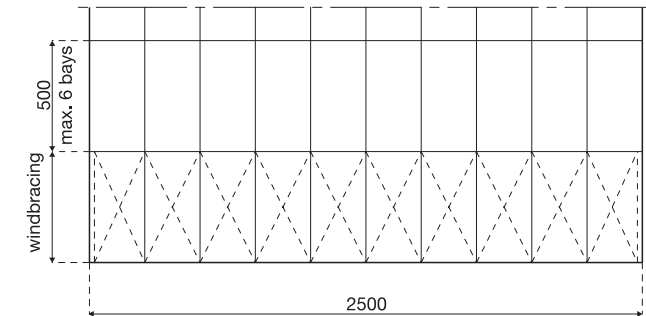
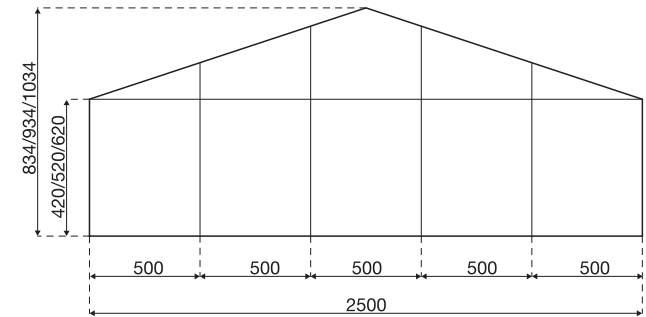

Optional Accessories

- 40/60/80mm Insulated walling
- Corrugated steel sheet walling
- Water sealed walls
- Fire sprinkler systems
- Black-out roof systems
- PVC or steel guttering
- Heating & air conditioning
- Canopies & racking
- Glazed windows & lighting
- Roller & sliding doors
- Personnel door unit



Frame Specifications

Span width:
30.00m

Eave height:
5.20m | 6.20m

Ridge height:
10.20m | 11.20m

Bay spacing:
5.00m

Roof pitch:
18.00°

Longest component:
10.80m

Wind loading:
100.00km/h (0.47kN/m²)

Snow loading:
75.00kg/m²

Profiles & Connections

Upright truss:
334/122/8mm

Eave purlin:
120/120/5mm

Intermediate purlin:
120/80/5mm

Ridge purlin:
120/80/5mm

Eave connection:
Galvanised steel insert

Material Specifications

Aluminium (framework)
Hard pressed extruded aluminium

Steel (connections)
European - hot dipped galvanised to DIN 50976

PVC covering
Available in single layer or thermo style - manufactured from high gloss translucent or opaque PVC coated polyester flame retardant according to DIN 4102 B1, M.2., B.S. 5438 / 7837, USA NFPA 701.

Flooring Systems

System 1
Heavy duty sub-construction floor

System 2
Cassette flooring system

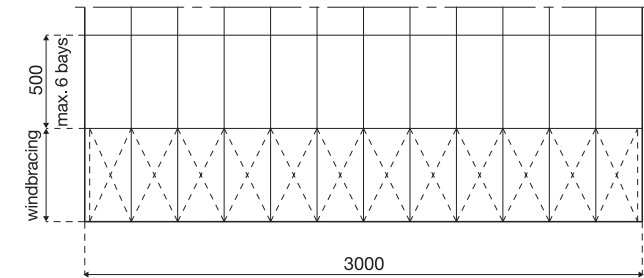
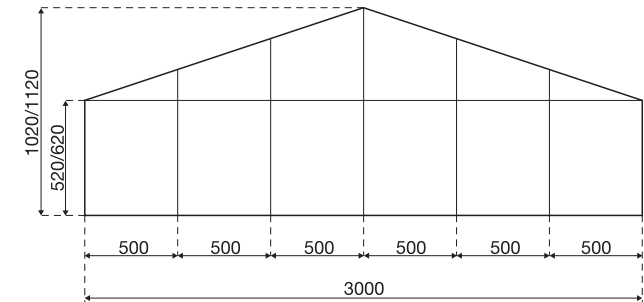

Optional Accessories

40/60/80mm Insulated walling	Canopies & racking
Corrugated steel sheet walling	Glazed windows & lighting
Water sealed walls	Roller & sliding doors
Fire sprinkler systems	Personnel door unit
Black-out roof systems	
PVC or steel guttering	
Heating & air conditioning	



Contacts

Main Worldwide Subsidiaries:

RÖDER HTS HÖCKER - Head Office & Production

Hinter der Schlagmühle 1
D-63699 Kefenrod
Germany

t: +49 (0) 6049 9510-0
f: +49 (0) 6049 9510-20
e: verkauf@roeder-hts.de
www.roeder-hts.de

RÖDER HTS HÖCKER - Sales & Distribution Centre

Unit 3 Lawrence Way
Stanhope Road
Yorktown Industrial Estate
Camberley
Surrey
GU15 3DL
United Kingdom

t: +44 (0) 870 242 6056
f: +44 (0) 870 242 6057
www.roderhts.com

HTS STRUCTURES - Sales & Distribution Centre

2200A Lynch Road
Evansville
IN 47711
Indiana
United States of America

t: +1 (0) 812 491 2260
f: +1 (0) 812 491 2263
www.hts-structures.com

RÖDER HTS HÖCKER - Sales & Design Office

Bureau Français
3 Rue Des Pruniers
F-67670 Mommenheim
France

t: +33 (0) 388 591 668
f: +33 (0) 388 591 623
www.roeder-hts-hocker.com

RÖDER HTS HÖCKER - Sales & Design Office

C/ Arquitecto Azemar 1
17600 Figueras
Spain

t: +34 (0) 9 72 51 20 83
f: +34 (0) 9 72 51 20 83
www.roderhts.com

Other Worldwide Offices:

Australia - Austria - Canada - Italy - Latin America & Caribbean -
Middle East - New Zealand - Netherlands - Poland - Russia -
Switzerland - Singapore - South Africa - Czech Republic

